



100GHz Dual Channel OADM (3x3)

AC Photonics' 100GHz Dense Wavelength Division Multiplexer (DWDM) utilizes thin film coating technology and proprietary design of non-flux metal bonding micro optics packaging to achieve optical add and drop at the ITU wavelengths. It provides ITU channel center wavelength, low insertion loss, high channel isolation, wide pass band, low temperature sensitivity and epoxy free optical path. It can be used for wavelength add/drop in telecommunication network system. All AC Photonics' products are Telcordia qualification tested.



Features

- 100GHz ITU Channel Spacing
- Low Insertion Loss
- Wide Pass Band
- High Channel Isolation
- High Stability and Reliability
- Epoxy Free Optical Path

Applications

- Channel Add / Drop
- DWDM Network
- Wavelength Routing
- Fiber Optical Amplifier
- CATV Fiberoptic System

Performance Specifications

| Parameter | MUX | DEMUX |
|--|-------------------------------------|-------|
| Channel Wavelength (nm) | 1530.33 ~ 1560.61 (21~ 59 ITU grid) | |
| Center Wavelength Accuracy (nm) | ±0.05 | |
| Minimum Channel Spacing (GHz) | 100 | |
| Channel Passband (@-0.5dB bandwidth) (nm) | ≥0.22 | |
| Insertion Loss (dB) | Add / Drop Ch.1 | ≤ 1.2 |
| | Add / Drop Ch.2 | ≤ 1.5 |
| | Express Ch. | ≤ 1.4 |
| Add / Drop Channel Ripple (dB) | ≤ 0.3 | |
| Isolation @Add/Drop Channel (dB) | Adjacent | N/A |
| | Non-adjacent | N/A |
| Express Channel Isolation (dB) | ≥ 25 | |
| Insertion Loss Temperature Sensitivity (dB/ °C) | ≤0.003 | |
| Wavelength Temperature Shifting (nm/ °C) | ≤0.002 | |
| PDL (dB) | ≤0.10 | |
| Polarization Mode Dispersion (ps) | ≤0.1 | |
| Directivity (dB) (Input to adds, Output to drops, adds to drops) | ≥50 | |
| Return Loss (dB) | ≥45 | |
| Power Handling (mW) | 300 | |
| Operating Temperature (°C) | 0 ~+70 | |
| Storage Temperature (°C) | -40 ~+85 | |
| Dimensions (mm) | L80 x W50 x H6 | |

Specifications may change without notice.

Ordering Information

| OADM | <input type="checkbox"/> | <input type="checkbox"/> <input type="checkbox"/> | <input type="checkbox"/> <input type="checkbox"/> <input type="checkbox"/> | <input type="checkbox"/> | <input type="checkbox"/> | <input type="checkbox"/> <input type="checkbox"/> |
|------|--------------------------|---|--|---|--------------------------|--|
| | Channel Spacing | Number of Channels | 1st ITU Channel | Pigtail Style | Fiber Length | In/Out Connector |
| | 1=100GHz | 02=2 Channel : : | C21=1560.61nm C22=1559.79nm C23=1558.98nm | 1=Bare Fiber 2=900um Jacket 3=3mm Cable | 1=1m 2=2m | 0=None 1=FC/APC 2=FC/PC 3=SC/APC 4=SC/PC 5=ST 6=LC |

Package Dimensions

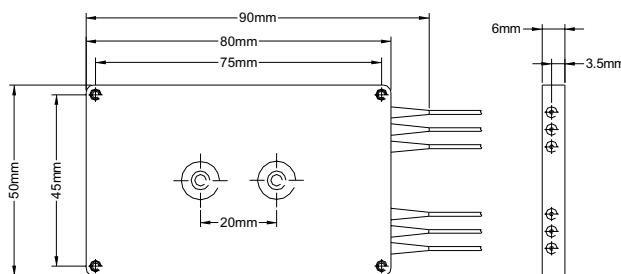

Spectral Chart

